

# Polyurethane Bushes

Previous urethane materials have had many shortcomings either being excessively too hard or too soft. Powerdown's Tuff Yello range of urethane products solves these problems with its exclusive formula and manufacturing process.

They have been designed and field tested under normal working conditions and have returned an average of 3 to 4 times the life span of their rubber equivalents. Tuff Yello components have an extremely high memory factor, meaning they will always return to their original shape rapidly and are unaffected by petroleum based products, offering extended service life.



Different bush types include:

Hour glass eye (EB) Half and full bushes available

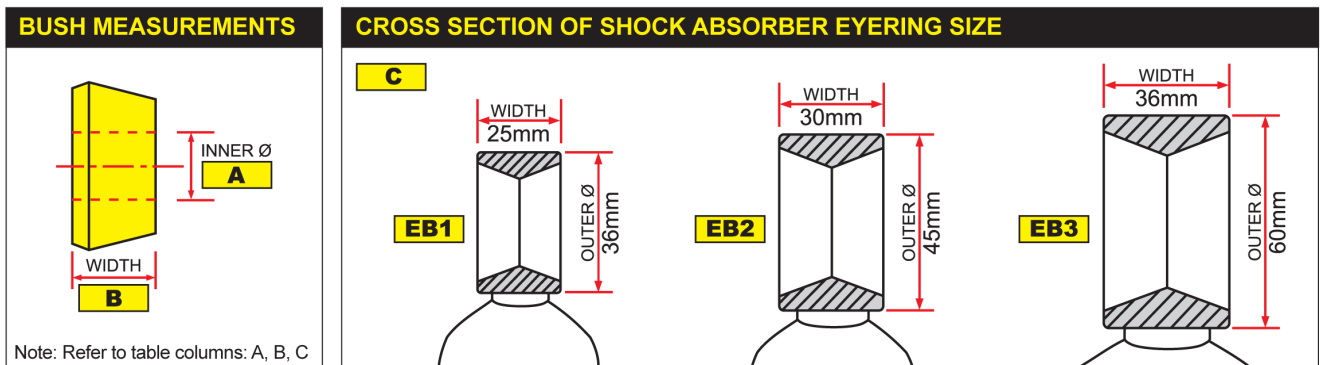

Parallel Bushes (Cotton Reel)

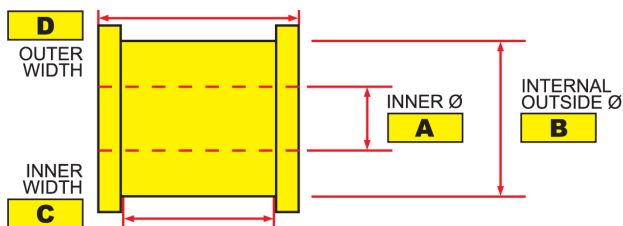

Round (Flat) pin type bushes

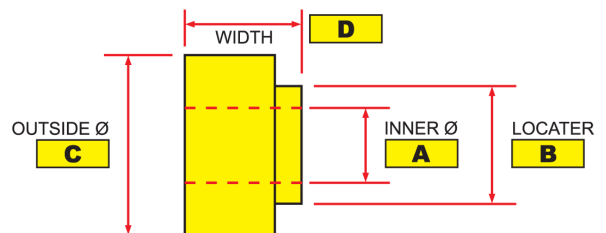

Continue reading over the page to learn how to correctly fit shock bushes.

## Fitting shock bushes

This is an important process when changing your shock absorbers, by following the simple steps below you will help extend the life of your shock absorbers.

- Use soapy water or poly grease to fit bushes
- **DO NOT** use graphite grease
- Ensure there is not a lot of rust or excessive debris in eye ring or on pin this will “flog out” the bush prematurely
- **DO NOT** overtighten poly bushes. This will cause bulging and will cause the bush to become damaged or wear out prematurely.

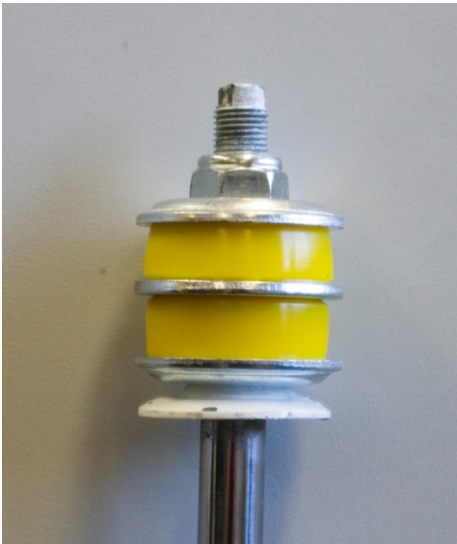

Over Tightened



Over Tightened



Over Tightened